

S321

- Prigioniere singolo (DIN 6379)
- Single stud (DIN 6379)

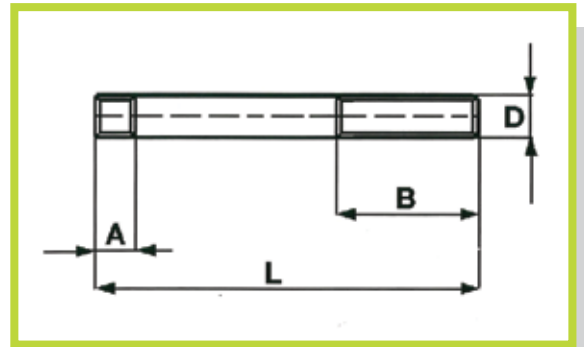

Materiale: UNI 42 CrMo4 a norma
ASTM A 193-B7 Classe 10.9. filetto ottenuto per rullatura

Material: UNI 42 CrMo4 According to standard
ASTM A 193-B7 Class 10.9. rolled thread

Esempio di ordinativo : Codice
Example of purchasing order : Code

Codice/Code	D	L	A	B	gr	Codice/Code	D	L	A	B	gr	Codice/Code	D	L	A	B	gr
S321.08040	M8	40	11	20	13	S321.16065	M16	63	19	35	85	S321.24100	M24	100	35	45	290
S321.08060		63		40	20	S321.16080		80		50	105	S321.24125		125		70	380
S321.08080		80		50	25	S321.16100		100		63	130	S321.24160		160		100	470
S321.08100		100		63	30	S321.16125		125		75	160	S321.24200		200		125	580
S321.08125		125		75	36	S321.16160		160		100	220	S321.24225		225		125	670
S321.08160		160		100	45	S321.16200		200		125	280	S321.24250		250		160	730
S321.08200		200		100	65	S321.16225		225		160	295	S321.24315		315		180	920
S321.10050	M10	50	13	25	25	S321.16250	M18	250	23	160	325	S321.27125	M27	125	39	56	485
S321.10060		60		35	30	S321.16315		315		180	425	S321.27150		150		80	570
S321.10080		80		50	40	S321.18080		80		50	130	S321.27200		200		125	770
S321.10100		100		75	50	S321.18100		100		50	165	S321.27225		225		160	860
S321.10120		120		75	65	S321.18125		125		75	200	S321.27250		250		160	960
S321.10160		160		100	80	S321.18160		160		100	255	S321.27315		315		200	1110
S321.10200		200		125	100	S321.18200		200		125	320	S321.27400		400		250	1535
S321.12050	M12	50	15	25	37	S321.18225	M20	225	27	150	365	S321.27500	M30	500	43	315	1930
S321.12060		63		32	45	S321.18250		250		150	400	S321.30125		125		56	590
S321.12080		80		50	55	S321.18315		315		180	500	S321.30150		150		80	710
S321.12100		100		63	70	S321.20080		80		32	185	S321.30200		200		125	950
S321.12125		125		75	90	S321.20125		125		70	255	S321.30250		250		160	1180
S321.12160		160		100	115	S321.20160		160		100	330	S321.30315		315		200	1490
S321.12200		200		125	140	S321.20200		200		125	410	S321.30400		400		250	1880
S321.12225	225	160	165	S321.20225	225	160	465	S321.30500	500	315	2360						
S321.12250	250	160	180	S321.20250	250	160	510	S321.30700	700	400	3300						
S321.14060	M14	63	17	32	80	S321.20315	M22	315	31	200	640	S321.36160	M36	160	51	80	1100
S321.14080		80		50	80	S321.22100		100		45	270	S321.36200		200		125	1340
S321.14100		100		63	95	S321.22120		120		63	300	S321.36250		250		160	1710
S321.14120		120		75	120	S321.22160		160		100	430	S321.36315		315		200	2150
S321.14160		160		100	150	S321.22200		200		125	500	S321.36400		400		250	2740
S321.14200		200		125	195	S321.22225		225		160	570	S321.36500		500		315	3540
S321.14225		225		160	225	S321.22250		250		160	670	S321.36700		700		400	4780
S321.14250	250	160	240	S321.22315	315	250	750										