

## R0379

### Innesto rapido filetto maschio con valvola / Male thread quick plug with valve

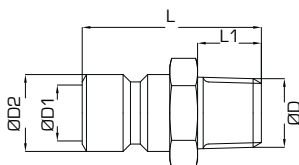

| Ordine Nr. / Order No. |               | ØD      | D1 | D2   | L    | L1 | ES. HEX. |
|------------------------|---------------|---------|----|------|------|----|----------|
| BSPT                   | NPT           |         |    |      |      |    |          |
| R0379-09-0001          | R0379-09-0011 | 1/4"    | 6  | 9.4  | 29   | 12 | 14       |
| R0379-09-0002          | R0379-09-0012 | 3/8"    | 6  | 9.4  | 29   | 12 | 17       |
| R0379-09-0003          |               | M14x1.5 | 6  | 9.4  | 29   | 12 | 15       |
| R0379-09-0004          | R0379-09-0013 | 1/4"    | 9  | 13.5 | 32.5 | 12 | 14       |
| R0379-09-0005          | R0379-09-0014 | 3/8"    | 9  | 13.5 | 32.5 | 12 | 17       |
| R0379-09-0006          | R0379-09-0015 | 1/2"    | 9  | 13.5 | 37   | 16 | 22       |
| R0379-09-0007          |               | M14x1.5 | 6  | 13.5 | 30   | 10 | 15       |
| R0379-09-0008          |               | M16x1.5 | 9  | 13.5 | 30   | 10 | 17       |
| R0379-09-0009          | R0379-09-0016 | 1/2"    | 15 | 20   | 45.5 | 12 | 22       |
| R0379-09-0010          | R0379-09-0017 | 3/4"    | 15 | 20   | 45.5 | 16 | 27       |

## R0380

### Innesto rapido filetto femmina / Female thread quick plug

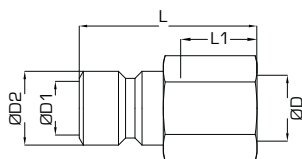

| Ordine Nr. / Order No. | ØD       | D1 | D2   | L  | L1 | ES. HEX. |
|------------------------|----------|----|------|----|----|----------|
| R0380-09-0001          | BSP 1/8" | 6  | 9.4  | 26 | 7  | 13       |
| R0380-09-0002          | BSP 1/4" | 6  | 9.4  | 29 | 9  | 16       |
| R0380-09-0003          | BSP 3/8" | 6  | 9.4  | 32 | 9  | 19       |
| R0380-09-0004          | BSP 1/8" | 9  | 13.5 | 37 | 9  | 17       |
| R0380-09-0005          | BSP 1/4" | 9  | 13.5 | 37 | 9  | 19       |
| R0380-09-0006          | BSP 3/8" | 9  | 13.5 | 40 | 12 | 24       |

## R0381

### Innesto rapido con prolunga / Quick plug with extension

| Ordine Nr. / Order No. | ØD | D1 | D2   | L   | L1  | ES. HEX. |
|------------------------|----|----|------|-----|-----|----------|
| R0381-09-0001          | 8  | 6  | 9.4  | 63  | 46  | 11       |
| R0381-09-0002          | 8  | 6  | 9.4  | 100 | 77  | 11       |
| R0381-09-0003          | 10 | 6  | 9.4  | 120 | 103 | 11       |
| R0381-09-0004          | 10 | 6  | 9.4  | 240 | 223 | 11       |
| R0381-09-0005          | 10 | 6  | 9.4  | 360 | 343 | 11       |
| R0381-09-0006          | 14 | 9  | 13.5 | 150 | 127 | 14       |
| R0381-09-0007          | 14 | 9  | 13.5 | 300 | 277 | 14       |

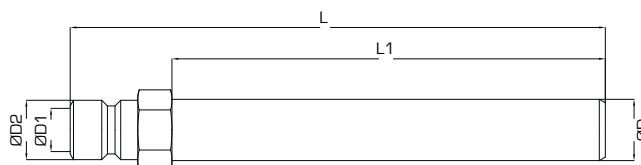

Esempio di ordinativo: Codice  
Example of purchasing order: Code