

N13

- Bussola a scorrimento di sfera
- Sphere sliding bush

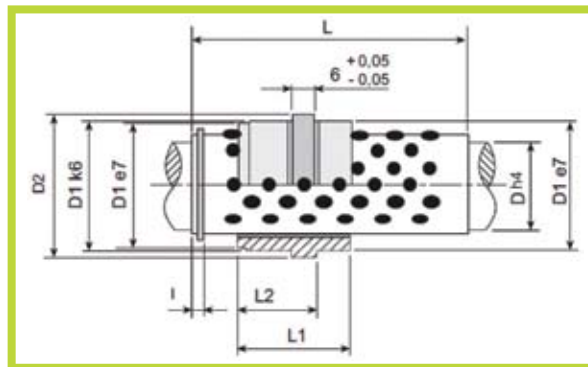

Esempio di ordinativo: Codice x D x L
Example of purchasing order: Code x D x L

| Codice Code | D | L | D1 | D2 | I | L1 | L2 | Corsa max Race max |
|-------------|----|----|----|----|-----|----|----|--------------------|
| N13 | 12 | 40 | 22 | 26 | 2,5 | 24 | 18 | 50 |
| N13 | 12 | 56 | 22 | 26 | 2,5 | 24 | 18 | 82 |
| N13 | 18 | 45 | 30 | 35 | 2,8 | 34 | 23 | 44 |
| N13 | 18 | 56 | 30 | 35 | 2,8 | 34 | 23 | 66 |
| N13 | 18 | 71 | 30 | 35 | 2,8 | 34 | 23 | 96 |
| N13 | 30 | 56 | 46 | 52 | 4,8 | 54 | 33 | 32 |
| N13 | 30 | 75 | 46 | 52 | 4,8 | 54 | 33 | 70 |
| N13 | 30 | 95 | 46 | 52 | 4,8 | 54 | 33 | 110 |

N130

- Bussola esterna
- External bush



Materiale: 1.7139
Material: 1.7139

| Codice Code | D | D1 | D2 | L1 | L2 | B |
|-------------|----|----|----|----|----|----|
| N130 | 16 | 22 | 26 | 24 | 18 | 6 |
| N130 | 24 | 30 | 35 | 34 | 23 | 11 |
| N130 | 38 | 46 | 52 | 54 | 33 | 21 |

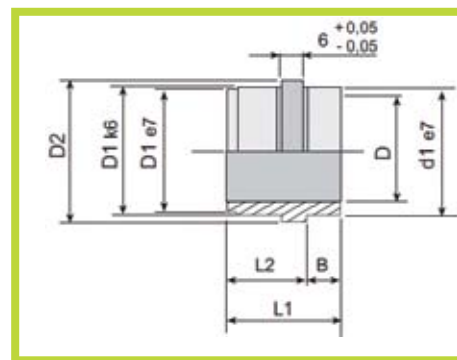

Esempio di ordinativo: Codice x D
Example of purchasing order: Code x D

N131

- Bussola con sfera
- Bush with sphere



| Codice Code | D | L | D1 | D2 | I |
|-------------|----|----|------|----|-----|
| N131 | 12 | 40 | 20,5 | 16 | 2,5 |
| N131 | 12 | 56 | 20,5 | 16 | 2,5 |
| N131 | 18 | 45 | 28,6 | 24 | 2,8 |
| N131 | 18 | 56 | 28,6 | 24 | 2,8 |
| N131 | 18 | 71 | 28,6 | 24 | 2,8 |
| N131 | 30 | 56 | 43,5 | 38 | 4,8 |
| N131 | 30 | 75 | 43,5 | 38 | 4,8 |
| N131 | 30 | 95 | 43,5 | 38 | 4,8 |

Materiale: Ottone
Material: Brass

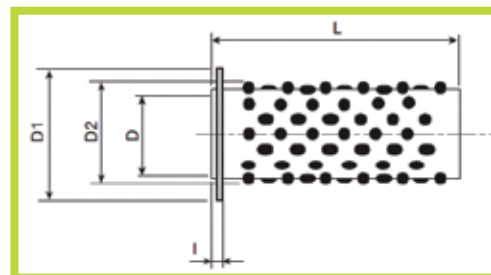

Esempio di ordinativo: Codice x D x L
Example of purchasing order: Code x D x L