

# BRT

- Barra temprata e rettificata  
- Grinded and Hardened Bar

# RANCO

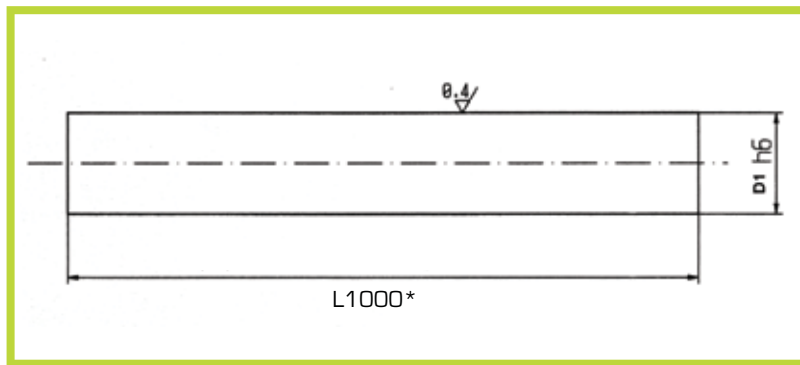

Materiale: CF 53

Material: CF 53

Durezza: HRC 62 - 64

Hardness: HRC 62 - 64

Esecuzione: barra temprata a induzione

Execution: Induction tempering

Profondità tempra: Ø 4 - 28 = 0,8 - 1,8 mm

Tempering depth: Ø 30 - 50 = 2 - 2,5 mm

Ø 60 - 100 = 2,8 - 3,5 mm

Esempio di ordinativo: BRT D1x1000 (con barra lunghezza standard)  
o BRT D1xL (indicare in "L" la lunghezza desiderata)

Example of purchasing order: BRT D1x1000 (with standard size bar)  
or BRT D1xL (put on the place of "L" the desired size)

CODICE	D1 Ø
BRT004X1000	4
BRT005X1000	5
BRT006X1000	6
BRT008X1000	8
BRT010X1000	10
BRT012X1000	12
BRT014X1000	14
BRT015X1000	15
BRT016X1000	16
BRT018X1000	18
BRT020X1000	20
BRT022X1000	22
BRT024X1000	24
BRT025X1000	25
BRT028X1000	28
BRT030X1000	30
BRT032X1000	32
BRT035X1000	35
BRT040X1000	40
BRT045X1000	45
BRT050X1000	50
BRT060X1000	60
BRT070X1000	70
BRT080X1000	80
BRT100X1000	100

\*=Lunghezze diverse disponibili a richiesta  
\*=Different sizes available upon request