

R0634

Golfare ad anello orientabile
Swivel point

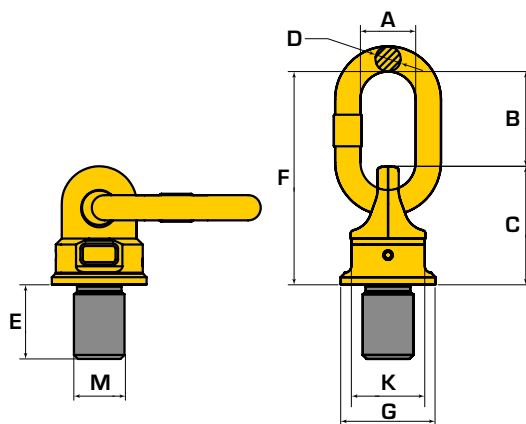

Descrizione:

Description:

Cod.	Limite di carico Working Load Limit (t*)			Filettatura Thread	Mom. torcen. Torque (Nm)	N.W. (kg)	Dimensioni Dimension (mm)							
	X	Y	Z				A	B	C	D	E	F	G	K
R0634-01-0001	0.45	0.6	0.9	M10 x 1.5	10	0.2	29	32	40	8	15	72	35	30
R0634-01-0002	0.6	0.7	1.2	M12 x 1.75	10	0.3	35	50	45	10	18	95	40	36
R0634-01-0003	1.3	1.5	2.6	M16 x 2	30	0.5	38	50	54	13	24	104	46	41
R0634-01-0004	2	2.5	4	M20 x 2.5	70	1	38	54	68	13	30	122	62	55
R0634-01-0005	3.5	4	7	M24 x 3	150	2.2	40	66	88	19	36	154	78	70
R0634-01-0006	5	6	10	M30 x 3.5	350	4.5	50	86	120	22	46	206	90	80
R0634-01-0007	8	10	15	M36 x 4	410	4.6	50	86	120	22	55	206	90	80
R0634-01-0008	13	13	17	M42 x 4.5	550	5.5	65	110	122	25	64	235	98	84
R0634-01-0009	14	16	18	M48 x 5	550	6.1	65	110	122	25	73	235	98	84
R0634-01-0010	20	22	28	M64 x 6	800	11.6	70	120	150	32	95	270	120	94

Cod. Ranco	Cod. Yoke
R0634-01-0001	8-271-004
R0634-01-0002	8-271-006
R0634-01-0003	8-271-013
R0634-01-0004	8-271-020
R0634-01-0005	8-271-035

Cod. Ranco	Cod. Yoke
R0634-01-0006	8-271-060
R0634-01-0007	8-271-080
R0634-01-0008	8-271-120
R0634-01-0009	8-271-130
R0634-01-0010	8-271-161

R0634

Golfare ad anello orientabile
Swivel point



Direzione di Carico
Load direction

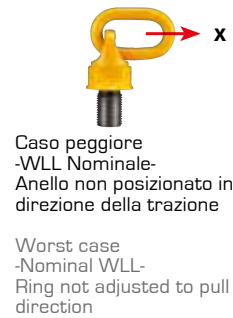

	Numero di gambe Number of legs	Direzione di Carico Load direction	Cod. 0634-01-	0001	0002	0003	0004	0005	0006	0007	0008	0009	0010
			Filett. Thread	M10	M12	M16	M20	M24	M30	M36	M42	M48	M64
	1	0°		0.9	1.2	2.6	4	7	10	15	17	18	28
	2	0°		1.8	2.4	5.2	8	14	20	30	34	36	56
	1	90°		0.45 (0.6)	0.6 (0.7)	1.3 (1.5)	2 (2.5)	3.5 (4)	5 (6)	8 (10)	13 (13)	14 (16)	20 (22)
	2	90°		0.9 (1.2)	1.2 (1.5)	2.6 (3)	4 (5)	7 (8)	10 (12)	16 (20)	26 (26)	28 (32)	40 (44)
	2	0 - 45°		0.6	0.8	1.8	2.8	4.9	7	11.2 (14)	18.2 (18.2)	19.6 (22.4)	28 (30.8)
	2	45° - 60°		0.4	0.6	1.3	2	3.5	5	8 (10)	13 (13)	14 (16)	20 (22)
	2	assimm. unsymm.		0.4	0.6	1.3	2	3.5	5	8 (10)	13 (13)	14 (16)	20 (22)
	3 - 4	0° - 45°		0.9	1.2	2.7	4.2	7.3	10.5	16.8 (21)	27.3 (27.3)	29.4 (33.6)	42 (46.2)
	3 - 4	45° - 60°		0.6	0.9	1.9	3	5.2	7.5	12 (15)	19.5 (19.5)	21 (24)	30 (33)
	3 - 4	assimm. unsymm.		0.4	0.6	1.3	2	3.5	5	8 (10)	13 (13)	14 (16)	20 (22)